

ROLLED PINS

785-392-3017 FAX 785.392.2845

REVISED 06-04
www.huyett.com

KNOWN AS EXPAN-PINS OR SPRING PINS

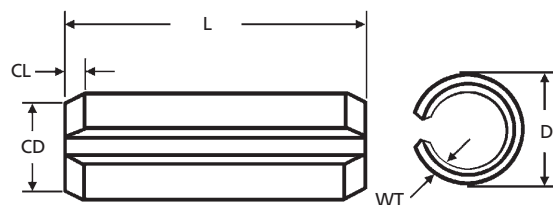

| SLOTTED | | | | | | | |
|------------------------------|-------------|-----------------|---------------------------|-----------------------|----------------------------------|---------------------|-------------------------------|
| MANUFACTURER CROSS-REFERENCE | | | | | | | |
| Spirol | | ITW/Bee-Leitzke | | 18/20 | | | |
| Vogelsang | | P19 | | | | | |
| SP | Nominal (D) | Length (L) | Diameter (D) Min / Max | Chamfer Diameter (CD) | Chamfer Length (CL) Min / Max | Wall Thickness (WT) | WEIGHT Lbs. per 100 Pieces |
| | DIAMETER | LENGTH | | | | | |
| -062-0187 | 1/16 | 3/16 | .066/.069 | .059 | .007/.028 | .012 | 0.01 |
| -062-0250 | | 1/4 | | | | | 0.01 |
| -062-0312 | | 5/16 | | | | | 0.02 |
| -062-0375 | | 3/8 | | | | | 0.02 |
| -062-0437 | | 7/16 | | | | | 0.02 |
| -062-0500 | | 1/2 | | | | | 0.03 |
| -062-0562 | | 9/16 | | | | | 0.03 |
| -062-0625 | | 5/8 | | | | | 0.03 |
| -062-0687 | | 11/16 | | | | | 0.04 |
| -062-0750 | | 3/4 | | | | | 0.04 |
| -062-0812 | 5/64 | 13/16 | .083/.086 | .075 | .008/.032 | .018 | 0.04 |
| -062-0875 | | 7/8 | | | | | 0.05 |
| -062-0937 | | 15/16 | | | | | 0.05 |
| -062-1000 | | 1 | | | | | 0.05 |
| -078-0187 | | 3/16 | | | | | 0.02 |
| -078-0250 | | 1/4 | | | | | 0.03 |
| -078-0312 | | 5/16 | | | | | 0.03 |
| -078-0375 | | 3/8 | | | | | 0.04 |
| -078-0437 | | 7/16 | | | | | 0.05 |
| -078-0500 | | 1/2 | | | | | 0.05 |
| -078-0562 | 3/32 | 9/16 | .099/.103 | .091 | .008/.038 | .022 | 0.06 |
| -078-0625 | | 5/8 | | | | | 0.07 |
| -078-0687 | | 11/16 | | | | | 0.07 |
| -078-0750 | | 3/4 | | | | | 0.08 |
| -078-0812 | | 13/16 | | | | | 0.09 |
| -078-0875 | | 7/8 | | | | | 0.09 |
| -078-0937 | | 15/16 | | | | | 0.10 |
| -078-1000 | | 1 | | | | | 0.11 |
| -078-1125 | | 1-1/8 | | | | | 0.12 |
| -078-1250 | | 1-1/4 | | | | | 0.13 |
| -078-1375 | | 1-3/8 | | | | | 0.14 |
| -078-1500 | | 1-1/2 | | | | | 0.15 |
| -093-0187 | | 3/16 | | | | | 0.03 |
| -093-0250 | | 1/4 | | | | | 0.04 |
| -093-0312 | | 5/16 | | | | | 0.05 |
| -093-0375 | | 3/8 | | | | | 0.05 |
| -093-0437 | | 7/16 | | | | | 0.06 |
| -093-0500 | | 1/2 | | | | | 0.07 |
| -093-0562 | | 9/16 | | | | | 0.08 |
| -093-0625 | | 5/8 | | | | | 0.09 |
| -093-0687 | | 11/16 | | | | | 0.10 |
| -093-0750 | | 3/4 | | | | | 0.11 |
| -093-0812 | | 13/16 | | | | | 0.11 |

*Parts may be cadmium yellow at Huyett's option.

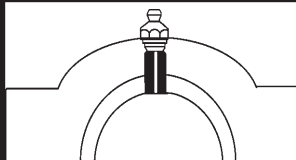
| SP | DESCRIPTION | GENERAL USE | HOW TO IDENTIFY | APPLICATION |
|----|---|---|---|---|
| | <p>A single-turn rolled pin, formed with one straight parallel slot. Slotted pins are economical and time saving as they can be installed in a single operation. The hollow design and slot give them their unique self-locking capabilities.</p> <p>SLOTTED</p> |  <p>COMMON</p> | <ol style="list-style-type: none"> 1. Verify single-turn roll with parallel slot. 2. Measure diameter (D). 3. Measure length (L). 4. Find the part in the chart above. <p>TYPICAL PART NUMBER SEQUENCE: SPP-062-0500 is a 1/16" x 1/2" plain carbon steel slotted pin.</p> |  <p>Acts as a lubricant passage in a bearing cavity.</p> |

PERFORMANCE RESULTS VARY. YOUR PIN SELECTION SHOULD BE MADE BASED ON INDIVIDUAL APPLICATION.

MOST SIZES AVAILABLE IMMEDIATELY • \$2 LINE REQUESTED • CALL PLANT FOR QUANTITY DISCOUNTS

KNOWN AS EXPAN-PINS OR SPRING PINS

BOX 232 • MINNEAPOLIS, KS • 67467

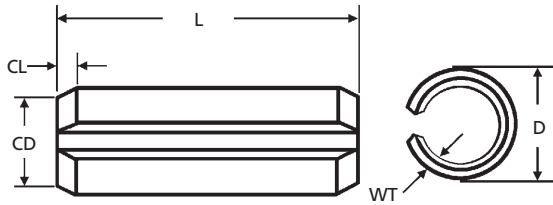

SLOTTED

MANUFACTURER CROSS-REFERENCE

| | | | |
|----------|---------|----------|------------|
| ASME | B18.8.2 | See also | NASM10971 |
| See also | MS16562 | See also | JIS B 2808 |



| SP | Nominal (D) | Length (L) | Diameter (D) Min / Max | Chamfer Diameter (CD) | Chamfer Length (CL) Min / Max | Wall Thickness (WT) | WEIGHT Lbs. per 100 Pieces | MATERIAL | | | |
|-----------|-------------|------------|---------------------------|-----------------------|----------------------------------|---------------------|-------------------------------|--------------|------------------|---------------------|-----------------|
| | DIAMETER | LENGTH | | | | | | Plain "SPP-" | Zinc Clear "SP-" | Zinc Yellow* "SPY-" | 300 SS "SPS3P-" |
| -093-0875 | 3/32 | 7/8 | .099/.103 | .091 | .008/.038 | .022 | 0.12 | | | | |
| -093-0937 | | 15/16 | | | | | 0.13 | | | | |
| -093-1000 | | 1 | | | | | 0.14 | | | | |
| -093-1125 | | 1-1/8 | | | | | 0.16 | | | | |
| -093-1250 | | 1-1/4 | | | | | 0.18 | | | | |
| -093-1375 | 1/8 | 1-3/8 | .131/.135 | .122 | .008/.044 | .028 | 0.19 | | | | |
| -093-1500 | | 1-1/2 | | | | | 0.21 | | | | |
| -125-0250 | | 1/4 | | | | | 0.06 | | | | |
| -125-0312 | | 5/16 | | | | | 0.08 | | | | |
| -125-0375 | | 3/8 | | | | | 0.09 | | | | |
| -125-0437 | 5/32 | 7/16 | .162/.167 | .151 | .010/.048 | .032 | 0.10 | | | | |
| -125-0500 | | 1/2 | | | | | 0.12 | | | | |
| -125-0562 | | 9/16 | | | | | 0.13 | | | | |
| -125-0625 | | 5/8 | | | | | 0.15 | | | | |
| -125-0687 | | 11/16 | | | | | 0.17 | | | | |
| -125-0750 | 1 | 3/4 | .162/.167 | .151 | .010/.048 | .032 | 0.18 | | | | |
| -125-0812 | | 13/16 | | | | | 0.20 | | | | |
| -125-0875 | | 7/8 | | | | | 0.21 | | | | |
| -125-0937 | | 15/16 | | | | | 0.23 | | | | |
| -125-1000 | | 1 | | | | | 0.24 | | | | |
| -125-1125 | 1-1/8 | 1-1/8 | .162/.167 | .151 | .010/.048 | .032 | 0.27 | | | | |
| -125-1250 | | 1-1/4 | | | | | 0.31 | | | | |
| -125-1375 | | 1-3/8 | | | | | 0.34 | | | | |
| -125-1500 | | 1-1/2 | | | | | 0.37 | | | | |
| -125-1625 | | 1-5/8 | | | | | 0.40 | | | | |
| -125-1750 | 1-1/4 | 1-3/4 | .162/.167 | .151 | .010/.048 | .032 | 0.44 | | | | |
| -125-1875 | | 1-7/8 | | | | | 0.48 | | | | |
| -125-2000 | | 2 | | | | | 0.50 | | | | |
| -156-0437 | 1-1/2 | 7/16 | .162/.167 | .151 | .010/.048 | .032 | 0.16 | | | | |
| -156-0500 | | 1/2 | | | | | 0.18 | | | | |
| -156-0562 | | 9/16 | | | | | 0.20 | | | | |
| -156-0625 | | 5/8 | | | | | 0.23 | | | | |
| -156-0687 | | 11/16 | | | | | 0.25 | | | | |
| -156-0750 | 1-1/8 | 3/4 | .162/.167 | .151 | .010/.048 | .032 | 0.27 | | | | |
| -156-0812 | | 13/16 | | | | | 0.30 | | | | |
| -156-0875 | | 7/8 | | | | | 0.32 | | | | |
| -156-0937 | | 15/16 | | | | | 0.35 | | | | |
| -156-1000 | | 1 | | | | | 0.37 | | | | |
| -156-1125 | 1-1/4 | 1-1/8 | .162/.167 | .151 | .010/.048 | .032 | 0.41 | | | | |
| -156-1250 | | 1-1/4 | | | | | 0.46 | | | | |
| -156-1375 | | 1-3/8 | | | | | 0.50 | | | | |
| -156-1500 | | 1-1/2 | | | | | 0.55 | | | | |
| -156-1625 | | 1-5/8 | | | | | 0.59 | | | | |

*Parts may be cadmium yellow at Huyett's option.

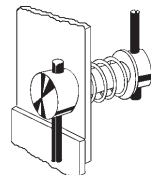
| SP | DESCRIPTION | GENERAL USE | HOW TO IDENTIFY | APPLICATION |
|----|--|---|---|--|
| | A single-turn rolled pin, formed with one straight parallel slot. Slotted pins are economical and time saving as they can be installed in a single operation. The hollow design and slot give them their unique self-locking capabilities. SLOTTED |  COMMON | <ol style="list-style-type: none"> 1. Verify single-turn roll with parallel slot. 2. Measure diameter (D). 3. Measure length (L). 4. Find the part in the chart above. <p>TYPICAL PART NUMBER SEQUENCE: SP-125-1000 is a 1/8" x 1" zinc clear slotted pin.</p> |  As a handle and as a latch. |

PERFORMANCE RESULTS VARY. YOUR PIN SELECTION SHOULD BE MADE BASED ON INDIVIDUAL APPLICATION.

MOST SIZES AVAILABLE IMMEDIATELY • \$2 LINE REQUESTED • CALL PLANT FOR QUANTITY DISCOUNTS

All manufacturer names and numbers are for identification purposes only. In no way are we implying that our parts were made by the manufacturers listed above. Prices, materials, tolerances, and grades subject to change without notice.

REVISED 06-04
www.huyett.com

www.huyett.com

Figure 1 shows two schematic diagrams of a C-shaped beam. The left diagram is a side view showing the beam's length L , its centerline CL , and its depth CD . The right diagram is a cross-sectional view showing the beam's outer diameter D and its wall thickness WT .



MANUFACTURER CROSS-REFERENCE

Spirol

ITW/Bee-Leitzke



18/20

Vogelsang

P19

| SP | Nominal (D) | Length (L) | Diameter (D) Min / Max | Chamfer Diameter (CD) | Chamfer Length (CL) Min / Max | Wall Thickness (WT) | WEIGHT Lbs. per 100 Pieces | MATERIAL | | | |
|---|----------------|---------------|------------------------------|-----------------------------|--|---------------------------|-------------------------------------|-----------------|---------------------|------------------------|--------------------|
| | DIAMETER | LENGTH | | | | | | Plain "SPP." | Zinc Clear "SP." | Zinc Yellow* "SPY." | 300 SS "SPS3P." |
| -156-1750 -156-1875 -156-2000 -156-2250 -156-2500 | 5/32 | 1-3/4 | .162/.167 | .151 | .010/.048 | .032 | 0.64 | | | | |
| -156-1875 | | 1-7/8 | | | | | 0.68 | | | | |
| -156-2000 | | 2 | | | | | 0.73 | | | | |
| -156-2250 | | 2-1/4 | | | | | 0.82 | | | | |
| -156-2500 | | 2-1/2 | | | | | 0.91 | | | | |
| -187-0375 -187-0437 -187-0500 -187-0562 -187-0625 -187-0687 -187-0750 -187-0812 -187-0875 -187-0937 | 3/16 | 3/8 | .194/.199 | .182 | .011/.055 | .040 | 0.20 | | | | |
| -187-0437 | | 7/16 | | | | | 0.23 | | | | |
| -187-0500 | | 1/2 | | | | | 0.25 | | | | |
| -187-0562 | | 9/16 | | | | | 0.29 | | | | |
| -187-0625 | | 5/8 | | | | | 0.32 | | | | |
| -187-0687 | | 11/16 | | | | | 0.35 | | | | |
| -187-0750 | | 3/4 | | | | | 0.39 | | | | |
| -187-0812 | | 13/16 | | | | | 0.42 | | | | |
| -187-0875 | | 7/8 | | | | | 0.45 | | | | |
| -187-0937 | | 15/16 | | | | | 0.49 | | | | |
| -187-1000 -187-1125 -187-1250 -187-1375 -187-1500 -187-1625 -187-1750 -187-1875 -187-2000 -187-2250 -187-2500 | 7/32 | 1 | .225/.232 | .214 | .011/.065 | .048 | 0.52 | | | | |
| -187-1125 | | 1-1/8 | | | | | 0.59 | | | | |
| -187-1250 | | 1-1/4 | | | | | 0.65 | | | | |
| -187-1375 | | 1-3/8 | | | | | 0.72 | | | | |
| -187-1500 | | 1-1/2 | | | | | 0.79 | | | | |
| -187-1625 | | 1-5/8 | | | | | 0.85 | | | | |
| -187-1750 | | 1-3/4 | | | | | 0.92 | | | | |
| -187-1875 | | 1-7/8 | | | | | 0.99 | | | | |
| -187-2000 | | 2 | | | | | 1.05 | | | | |
| -187-2250 | | 2-1/4 | | | | | 1.19 | | | | |
| -187-2500 | | 2-1/2 | | | | | 1.32 | | | | |
| -218-0562 -218-0625 -218-0687 -218-0750 -218-0812 -218-0875 -218-0937 -218-1000 -218-1125 -218-1250 -218-1375 -218-1500 -218-1625 -218-1750 -218-1875 -218-2000 -218-2250 | | 7/32 | | | | | 9/16 | .225/.232 | .214 | .011/.065 | .048 |
| -218-0625 | 5/8 | | 0.44 | | | | | | | | |
| -218-0687 | 11/16 | | 0.49 | | | | | | | | |
| -218-0750 | 3/4 | | 0.54 | | | | | | | | |
| -218-0812 | 13/16 | | 0.58 | | | | | | | | |
| -218-0875 | 7/8 | | 0.63 | | | | | | | | |
| -218-0937 | 15/16 | | 0.68 | | | | | | | | |
| -218-1000 | 1 | | 0.72 | | | | | | | | |
| -218-1125 | 1-1/8 | | 0.82 | | | | | | | | |
| -218-1250 | 1-1/4 | | 0.91 | | | | | | | | |
| -218-1375 | 1-3/8 | | 1.01 | | | | | | | | |
| -218-1500 | 1-1/2 | | 1.10 | | | | | | | | |
| -218-1625 | 1-5/8 | | 1.14 | | | | | | | | |
| -218-1750 | 1-3/4 | | 1.29 | | | | | | | | |
| -218-1875 | 1-7/8 | | 1.38 | | | | | | | | |
| -218-2000 | 2 | | 1.48 | | | | | | | | |
| -218-2250 | 2-1/4 | 1.66 | | | | | | | | | |

**Parts may be cadmium yellow at Huyett's option.*

| SP | DESCRIPTION | GENERAL USE | HOW TO IDENTIFY | APPLICATION |
|----|---|--|---|--|
| | <p>A single-turn rolled pin, formed with one straight parallel slot. Slotted pins are economical and time saving as they can be installed in a single operation. The hollow design and slot give them their unique self-locking capabilities.</p> <p>SLOTTED</p> |  <p>COMMON</p> | <ol style="list-style-type: none"> 1. Verify single-turn roll with parallel slot. 2. Measure diameter (D). 3. Measure length (L). 4. Find the part in the chart above. <p>TYPICAL PART NUMBER SEQUENCE: SPP-062-0500 <i>is a 1/16" x 1/2" plain carbon steel slotted pin.</i></p> |  <p>As a key to drive a hand wheel.</p> |

MOST SIZES AVAILABLE IMMEDIATELY • \$2 LINE REQUESTED • CALL PLANT FOR QUANTITY DISCOUNTS

KNOWN AS EXPAN-PINS OR SPRING PINS

BOX 232 • MINNEAPOLIS, KS • 67467

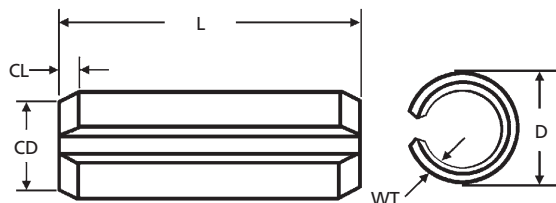

SLOTTED
MANUFACTURER CROSS-REFERENCE

| | | | |
|----------|---------|----------|------------|
| ASME | B18.8.2 | See also | NASM10971 |
| See also | MS16562 | See also | JIS B 2808 |



| SP | Nominal (D) | Length (L) | Diameter (D) | Chamfer Diameter (CD) | Chamfer Length (CL) | Wall Thickness (WT) | WEIGHT | MATERIAL | | | |
|-----------|-------------|------------|--------------|-----------------------|---------------------|---------------------|---------------------|--------------|------------------|---------------------|-----------------|
| | DIAMETER | LENGTH | Min / Max | | Min / Max | | Lbs. per 100 Pieces | Plain "SPP-" | Zinc Clear "SP-" | Zinc Yellow* "SPY-" | 300 SS "SPS3P-" |
| -218-2500 | 7/32 | 2-1/2 | .225/.232 | .214 | .011/.065 | .048 | 1.75 | | | | |
| -218-2750 | | 2-3/4 | | | | | 1.93 | | | | |
| -218-3000 | | 3 | | | | | 2.12 | | | | |
| -250-0500 | 1/4 | 1/2 | .258/.264 | .245 | .012/.065 | .048 | 0.43 | | | | |
| -250-0562 | | 9/16 | | | | | 0.46 | | | | |
| -250-0625 | | 5/8 | | | | | 0.49 | | | | |
| -250-0687 | | 11/16 | | | | | 0.55 | | | | |
| -250-0750 | | 3/4 | | | | | 0.62 | | | | |
| -250-0812 | | 13/16 | | | | | 0.68 | | | | |
| -250-0875 | | 7/8 | | | | | 0.74 | | | | |
| -250-0937 | | 15/16 | | | | | 0.80 | | | | |
| -250-1000 | | 1 | | | | | 0.86 | | | | |
| -250-1125 | | 1-1/8 | | | | | 0.97 | | | | |
| -250-1250 | | 1-1/4 | | | | | 1.07 | | | | |
| -250-1375 | | 1-3/8 | | | | | 1.21 | | | | |
| -250-1500 | | 1-1/2 | | | | | 1.33 | | | | |
| -250-1625 | | 1-5/8 | | | | | 1.45 | | | | |
| -250-1750 | | 1-3/4 | | | | | 1.56 | | | | |
| -250-1875 | | 1-7/8 | | | | | 1.68 | | | | |
| -250-2000 | | 2 | | | | | 1.80 | | | | |
| -250-2250 | | 2-1/4 | | | | | 2.03 | | | | |
| -250-2500 | | 2-1/2 | | | | | 2.27 | | | | |
| -250-2750 | | 2-3/4 | | | | | 2.50 | | | | |
| -250-3000 | | 3 | | | | | 2.74 | | | | |
| -250-3250 | | 3-1/4 | | | | | 2.98 | | | | |
| -250-3500 | | 3-1/2 | | | | | 3.21 | | | | |
| -312-0750 | 5/16 | 3/4 | .321/.330 | .306 | .014/.080 | .062 | 0.99 | | | | |
| -312-0812 | | 13/16 | | | | | 1.08 | | | | |
| -312-0875 | | 7/8 | | | | | 1.16 | | | | |
| -312-0937 | | 15/16 | | | | | 1.25 | | | | |
| -312-1000 | | 1 | | | | | 1.34 | | | | |
| -312-1125 | | 1-1/8 | | | | | 1.51 | | | | |
| -312-1250 | | 1-1/4 | | | | | 1.69 | | | | |
| -312-1375 | | 1-3/8 | | | | | 1.87 | | | | |
| -312-1500 | | 1-1/2 | | | | | 2.04 | | | | |
| -312-1625 | | 1-5/8 | | | | | 2.22 | | | | |
| -312-1750 | | 1-3/4 | | | | | 2.40 | | | | |
| -312-1875 | | 1-7/8 | | | | | 2.58 | | | | |
| -312-2000 | | 2 | | | | | 2.75 | | | | |
| -312-2250 | | 2-1/4 | | | | | 3.10 | | | | |
| -312-2500 | | 2-1/2 | | | | | 3.46 | | | | |
| -312-2750 | | 2-3/4 | | | | | 3.81 | | | | |
| -312-3000 | | 3 | | | | | 4.16 | | | | |

*Parts may be cadmium yellow at Huyett's option.

| SP | DESCRIPTION | GENERAL USE | HOW TO IDENTIFY | APPLICATION |
|----|--|--|---|---|
| | A single-turn rolled pin, formed with one straight parallel slot. Slotted pins are economical and time saving as they can be installed in a single operation. The hollow design and slot give them their unique self-locking capabilities. SLOTTED |  COMMON | 1. Verify single-turn roll with parallel slot. 2. Measure diameter (D). 3. Measure length (L). 4. Find the part in the chart above. TYPICAL PART NUMBER SEQUENCE: SP-125-1000 is a 1/8" x 1" zinc clear slotted pin. |  Use over wires to form a longitudinal friction stop. |

PERFORMANCE RESULTS VARY. YOUR PIN SELECTION SHOULD BE MADE BASED ON INDIVIDUAL APPLICATION.

MOST SIZES AVAILABLE IMMEDIATELY • \$2 LINE REQUESTED • CALL PLANT FOR QUANTITY DISCOUNTS

All manufacturer names and numbers are for identification purposes only. In no way are we implying that our parts were made by the manufacturers listed above. Prices, materials, tolerances, and grades subject to change without notice.

ROLLED PINS

785-392-3017 FAX 785.392.2845

REVISED 06-04
www.huyett.com

KNOWN AS EXPAN-PINS OR SPRING PINS

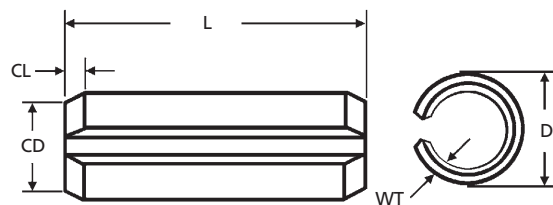

| SLOTTED | | | | |
|------------------------------|-----------|--|-----------------|-------|
| MANUFACTURER CROSS-REFERENCE | | | | |
| | Spirol | | ITW/Bee-Leitzke | |
| | Vogelsang | | P19 | |
| | | | | 18/20 |

| SP | Nominal (D) | Length (L) | Diameter (D) Min / Max | Chamfer Diameter (CD) | Chamfer Length (CL) Min / Max | Wall Thickness (WT) | WEIGHT Lbs. per 100 Pieces | MATERIAL | | | |
|-----------|-------------|------------|---------------------------|-----------------------|----------------------------------|---------------------|-------------------------------|--------------|------------------|---------------------|-----------------|
| | DIAMETER | LENGTH | | | | | | Plain "SPP." | Zinc Clear "SP." | Zinc Yellow* "SPY." | 300 SS "SPS3P." |
| -312-3250 | 5/16 | 3-1/4 | .321/.330 | .306 | .014/.080 | .062 | 4.51 | | | | |
| -312-3500 | | 3-1/2 | | | | | 4.86 | | | | |
| -312-3750 | | 3-3/4 | | | | | 5.21 | | | | |
| -312-4000 | | 4 | | | | | 5.56 | | | | |
| -375-0750 | 3/8 | 3/4 | .385/.395 | .368 | .016/.095 | .077 | 1.45 | | | | |
| -375-1000 | | 1 | | | | | 1.98 | | | | |
| -375-1250 | | 1-1/4 | | | | | 2.52 | | | | |
| -375-1500 | | 1-1/2 | | | | | 3.05 | | | | |
| -375-1750 | | 1-3/4 | | | | | 3.59 | | | | |
| -375-2000 | | 2 | | | | | 4.12 | | | | |
| -375-2250 | | 2-1/4 | | | | | 4.66 | | | | |
| -375-2500 | | 2-1/2 | | | | | 5.19 | | | | |
| -375-2750 | | 2-3/4 | | | | | 5.73 | | | | |
| -375-3000 | | 3 | | | | | 6.26 | | | | |
| -375-3250 | | 3-1/4 | | | | | 6.80 | | | | |
| -375-3500 | | 3-1/2 | | | | | 7.33 | | | | |
| -375-3750 | | 3-3/4 | | | | | 7.87 | | | | |
| -375-4000 | | 4 | | | | | 8.40 | | | | |
| -437-1000 | 7/16 | 1 | .448/.456 | .430 | .017/.095 | .077 | 2.50 | | | | |
| -437-1250 | | 1-1/4 | | | | | 3.15 | | | | |
| -437-1500 | | 1-1/2 | | | | | 3.79 | | | | |
| -437-1750 | | 1-3/4 | | | | | 4.43 | | | | |
| -437-2000 | | 2 | | | | | 5.07 | | | | |
| -437-2250 | | 2-1/4 | | | | | 5.71 | | | | |
| -437-2500 | | 2-1/2 | | | | | 6.36 | | | | |
| -437-2750 | | 2-3/4 | | | | | 7.00 | | | | |
| -437-3000 | | 3 | | | | | 7.64 | | | | |
| -437-3250 | | 3-1/4 | | | | | 8.28 | | | | |
| -437-3500 | | 3-1/2 | | | | | 8.92 | | | | |
| -437-3750 | | 3-3/4 | | | | | 9.57 | | | | |
| -437-4000 | | 4 | | | | | 10.21 | | | | |
| -500-1250 | 1/2 | 1-1/4 | .513/.524 | .485 | .025/.110 | .094 | 3.91 | | | | |
| -500-1500 | | 1-1/2 | | | | | 4.82 | | | | |
| -500-1750 | | 1-3/4 | | | | | 5.73 | | | | |
| -500-2000 | | 2 | | | | | 6.63 | | | | |
| -500-2250 | | 2-1/4 | | | | | 7.54 | | | | |
| -500-2500 | | 2-1/2 | | | | | 8.45 | | | | |
| -500-2750 | | 2-3/4 | | | | | 9.36 | | | | |
| -500-3000 | | 3 | | | | | 10.27 | | | | |
| -500-3250 | | 3-1/4 | | | | | 11.18 | | | | |
| -500-3500 | | 3-1/2 | | | | | 12.09 | | | | |
| -500-3750 | | 3-3/4 | | | | | 13.00 | | | | |
| -500-4000 | | 4 | | | | | 13.91 | | | | |

*Parts may be cadmium yellow at Huyett's option.

| SP | DESCRIPTION | GENERAL USE | HOW TO IDENTIFY | APPLICATION |
|----|---|---------------|---|---|
| | <p>A single-turn rolled pin, formed with one straight parallel slot. Slotted pins are economical and time saving as they can be installed in a single operation. The hollow design and slot give them their unique self-locking capabilities.</p> <p>SLOTTED</p> | <p>COMMON</p> | <ol style="list-style-type: none"> 1. Verify single-turn roll with parallel slot. 2. Measure diameter (D). 3. Measure length (L). 4. Find the part in the chart above. <p>TYPICAL PART NUMBER SEQUENCE: SPP-062-0500 is a 1/16" x 1/2" plain carbon steel slotted pin.</p> | <p>Used to assemble laminated handle.</p> |

PERFORMANCE RESULTS VARY. YOUR PIN SELECTION SHOULD BE MADE BASED ON INDIVIDUAL APPLICATION.

MOST SIZES AVAILABLE IMMEDIATELY • \$2 LINE REQUESTED • CALL PLANT FOR QUANTITY DISCOUNTS

METRIC SLOTTED SPRING PINS

| Nominal Diameter | Pin Diameter Minimum | | Pin Diameter Maximum | | Chamfer Length | | Wall Thickness | | Hole Size Minimum | | Hole Size Maximum | | Double Shear Min. (kN) | |
|------------------|----------------------|-------|----------------------|-------|----------------|-------|----------------|------|-------------------|-------|-------------------|-------|------------------------|--------|
| | ISO/DIN | ASME | ISO/DIN | ASME | ISO/DIN | ASME | ISO/DIN | ASME | ISO/DIN | ASME | ISO/DIN | ASME | ISO/DIN | ASME |
| 1.5 | 1.70 | 1.58 | 1.80 | 1.66 | 0.25 | 1.40 | 0.30 | 0.35 | 1.50 | 1.50 | 1.60 | 1.56 | 1.58 | 1.80 |
| 2.0 | 2.30 | 2.10 | 2.40 | 2.19 | 0.35 | 1.90 | 0.40 | 0.45 | 2.00 | 2.00 | 2.15 | 2.07 | 2.82 | 3.50 |
| 2.5 | 2.80 | 2.62 | 2.90 | 2.72 | 0.40 | 2.40 | 0.50 | 0.55 | 2.50 | 2.50 | 2.65 | 2.58 | 4.38 | 5.50 |
| 3.0 | 3.30 | 3.14 | 3.50 | 3.25 | 0.50 | 2.90 | 0.60 | 0.65 | 3.00 | 3.00 | 3.15 | 3.10 | 6.32 | 7.80 |
| 4.0 | 4.40 | 4.16 | 4.60 | 4.30 | 0.65 | 3.90 | 0.80 | 0.80 | 4.00 | 4.00 | 4.20 | 4.12 | 11.24 | 12.30 |
| 5.0 | 5.40 | 5.17 | 5.60 | 5.33 | 0.90 | 4.80 | 1.00 | 1.00 | 5.00 | 5.00 | 5.20 | 5.12 | 17.54 | 19.60 |
| 6.0 | 6.40 | 6.18 | 6.70 | 6.36 | 1.20 | 5.80 | 1.20 | 1.20 | 6.00 | 6.00 | 6.25 | 6.12 | 26.04 | 28.50 |
| 8.0 | 8.50 | 8.22 | 8.80 | 8.45 | 2.00 | 7.80 | 1.50 | 1.60 | 8.00 | 8.00 | 8.30 | 8.15 | 42.76 | 48.80 |
| 10.0 | 10.50 | 10.25 | 10.80 | 10.51 | 2.00 | 9.70 | 2.00 | 2.00 | 10.00 | 10.00 | 10.30 | 10.15 | 70.16 | 79.10 |
| 12.0 | 12.50 | 12.28 | 12.80 | 12.55 | 2.00 | 11.70 | 2.50 | 2.50 | 12.00 | 12.00 | 12.35 | 12.18 | 104.10 | 104.10 |

Metric sizes begin on page 196.

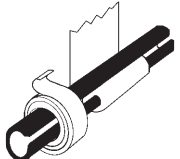
| | DESCRIPTION | GENERAL USE | HOW TO IDENTIFY | APPLICATION |
|-----------|--|---|--|--|
| SP | A single-turn rolled pin, formed with one straight parallel slot. Slotted pins are economical and time saving as they can be installed in a single operation. The hollow design and slot give them their unique self-locking capabilities. SLOTTED |  COMMON | 1. Verify single-turn roll with parallel slot. 2. Measure diameter (D). 3. Measure length (L). 4. Find the part in the chart above. |  As a shaft for a reel. |
| | | | TYPICAL PART NUMBER SEQUENCE: SP-125-1000 <i>is a 1/8" x 1" zinc clear slotted pin.</i> | |

PERFORMANCE RESULTS VARY. YOUR PIN SELECTION SHOULD BE MADE BASED ON INDIVIDUAL APPLICATION.

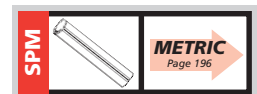

MOST SIZES AVAILABLE IMMEDIATELY • \$2 LINE REQUESTED • CALL PLANT FOR QUANTITY DISCOUNTS

All manufacturer names and numbers are for identification purposes only. In no way are we implying that our parts were made by the manufacturers listed above. Prices, materials, tolerances, and grades subject to change without notice.